

2200 Ramulus St.
 Los Angeles 90065
 (310) 256-0483

Attach to Stucco Wall @ 7⁹

Side Wall Extra 5' Hanger

Lower Level

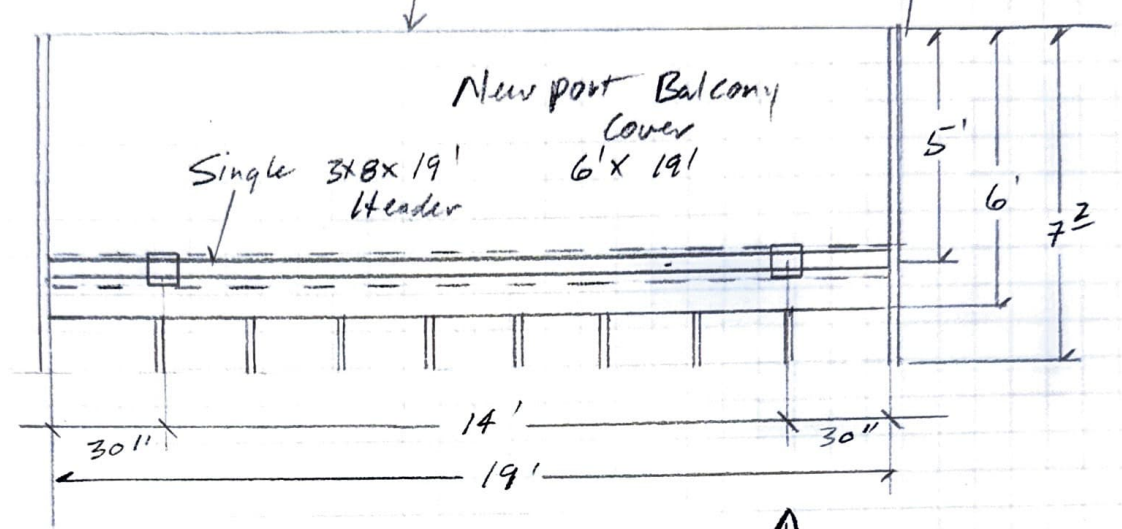

Vertical line up of Posts

Upper Level

Attach to Stucco Wall @ 7⁹

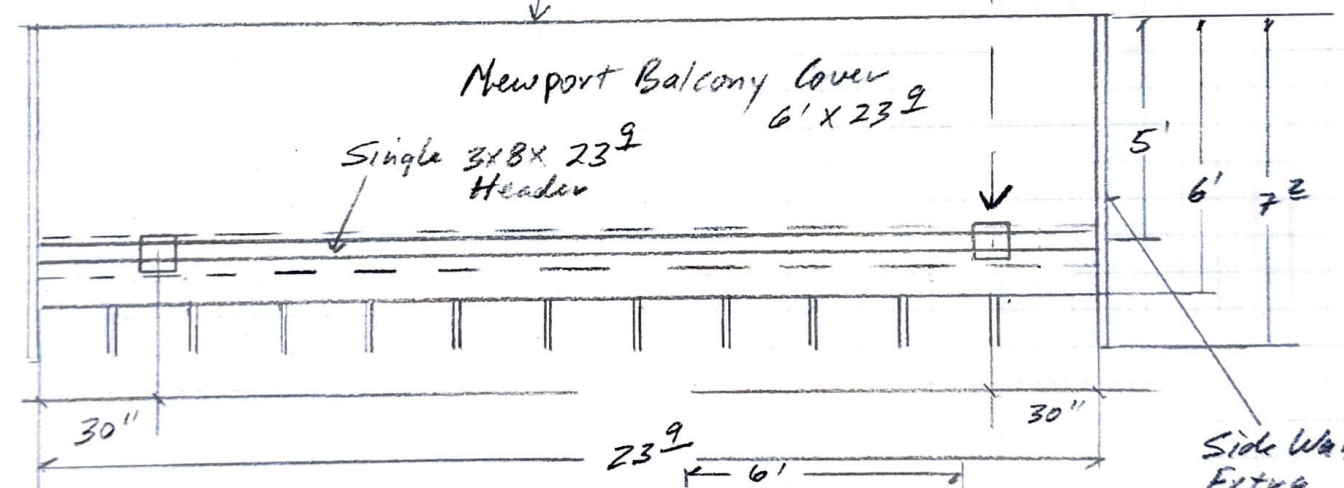

Side Wall Extra 5' Hanger.

Colon: All Adobe
 Ends: Bevel Slope 2"

8" Wall
 37" + 39" High
 w/ Tile Top.

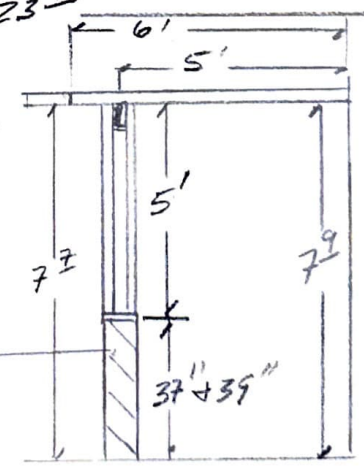

BOTH Levels ELEV.

GM Pac. Div

1/4